

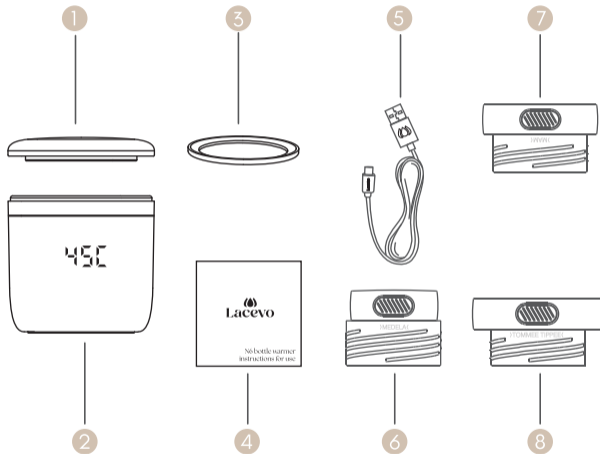

N6 bottle warmer
instructions for use

what's in the box?

- 1 SILICONE DUST COVER
- 2 LACEVO BOTTLE WARMER
- 3 SEALING RING
- 4 INSTRUCTIONS
- 5 USB-C CHARGING CABLE
- 6 NARROW NECK (MEDELA) ADAPTER
- 7 WIDE NECK (MAM) ADAPTER
- 8 TOMMEE TIPPEE ADAPTER



LED display & button functions

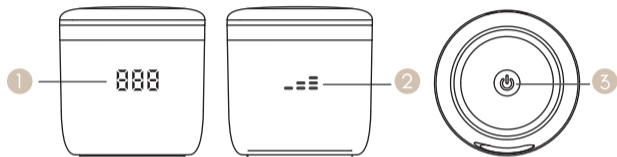

- 1 TEMPERATURE / BATTERY DISPLAY
- 2 CHARGING INDICATOR
- 3 POWER BUTTON

TIPS

THIS PRODUCT HAS A BUILT-IN LI-ION BATTERY. WHEN THE BATTERY LEVEL FALLS BELOW 20% THE DISPLAY WILL BRIEFLY SHOW LO. WE RECOMMEND THAT YOU USE A CERTIFIED USB-C FAST CHARGER TO CHARGE THE BOTTLE WARMER MOTOR AS SOON AS POSSIBLE.

bottle warmer assembly

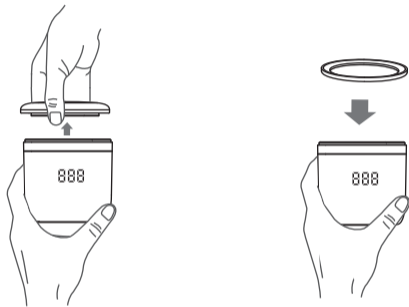

1. BEFORE USE, FIRSTLY REMOVE THE SILICONE DUST COVER

2. WITH THE LIP OF THE SEAL FACING UPWARDS, PUSH THE SEAL INTO THE METAL GROOVE IN THE RECESS OF THE BOTTLE WARMER, MAKING SURE IT SITS FLAT INTO THE BASE

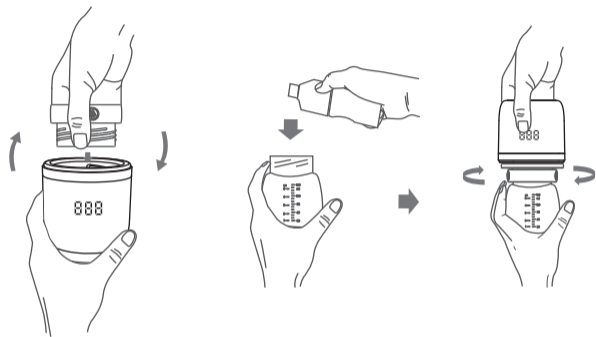

3. WHEN SCREWING THE BOTTLE ADAPTER OR BOTTLE INTO THE RECESS OF THE BOTTLE WARMER BE CAREFUL NOT TO OVER TIGHTEN TO AVOID DAMAGING THE ADAPTER OR BOTTLE.

4. FILL THE BOTTLE WITH WATER OR MILK AT ROOM TEMPERATURE, INVERT THE BODY OF THE BOTTLE WARMER, TURN AND TIGHTEN.

usage

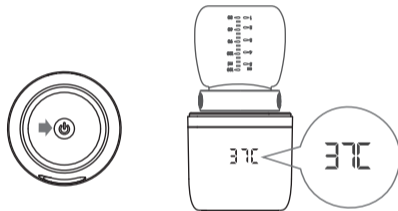

1. LONG PRESS THE POWER BUTTON "  " FOR 2 SECONDS TO START THE BOTTLE WARMER. A BEEP WILL SOUND ONCE AND THE DEFAULT WARM-TO-TEMPERATURE 37°C WILL FLASH. AFTER 2 SECONDS, HEATING STARTS AND THE DISPLAY WILL SHOW THE CURRENT TEMPERATURE OF THE WATER / MILK.

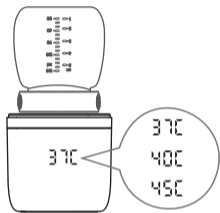

2. ONCE THE BOTTLE WARMER STARTS, SHORT PRESS THE POWER BUTTON "  " TO SWITCH TO YOUR PREFERRED WATER / MILK WARMING TEMPERATURE (37 C / 40 C / 45 C). AFTER THE WATER / MILK REACHES THE SELECTED TEMPERATURE, IT WILL CONTINUE TO KEEP WARM & DISPLAY CURRENT TEMPERATURE.

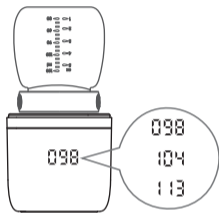

TO CHANGE THE TEMPERATURE TYPE FROM CELCIUS TO FAHRENHEIT WHEN THE WARMER IS TURNED OFF PRESS AND HOLD "  " FOR 4 SECONDS



3. QUICKLY PRESS THE POWER SWITCH TO TURN ON/OFF THE NIGHT LIGHT.

4. WHEN YOU HAVE FINISHED WARMING THE BOTTLE, LONG PRESS THE POWER BUTTON "  " TO TURN OFF THE BOTTLE WARMER.

LED battery level display

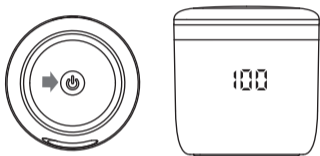

1. WHEN IT IS SWITCHED OFF, SHORT PRESS THE POWER BUTTON "  ", FOR THE DISPLAY SCREEN TO SHOW THE REMAINING PERCENTAGE OF BATTERY POWER.



2. WHEN THE BATTERY LEVEL FALLS BELOW 20%, THE DISPLAY WILL SHOW "LO." AFTER 2 SECONDS IT WILL SWITCH TO SHOW THE ACTUAL TEMPERATURE. WHEN THE BATTERY LOSES POWER IT WILL BEEP TWICE AND DISPLAY " LO " IT WILL THEN AUTOMATICALLY SWITCH OFF AFTER 6 SECONDS OF FLASHING. PLEASE CHARGE IN TIME.

3. WHEN THE WARMER IS SWITCHED OFF & CHARGING WITH THE USB-C CABLE, THE DISPLAY WILL SHOW 3 FLASHING BARS. ONCE IT IS FULLY CHARGED ALL 3 BARS WILL BE SOLID.

universal milk bottle

WE SUGGEST TESTING YOUR BOTTLE WITH WATER FIRST TO MAKE SURE YOU ARE USING THE CORRECT SEAL & ADAPTER IF NECESSARY. OUR WARMER FITS THE FOLLOWING BRANDS & MANY MORE WIDE NECK BOTTLES.

AVENT
RICHEL
CHU CHU
COMBI
HITO

UPIS
SPECTRA
DOUBLE HEART
SNOW BEAR
NIP

CHICCO
BEBE CONFORT
LANSINOH
BOBO
YOYO MONKEY

PIYOPIYO
US BABY
TUTU

THE USE OF SEALING RINGS

AS DIFFERENT BRANDS OF BOTTLES HAVE DIFFERENT SCREW THREADS, WE HAVE DESIGNED A SEAL THAT CAN BE USED FACING TWO DIFFERENT WAYS. THE WARMER COMES WITH THE L-SHAPE SEAL AND LIP OF THE SEAL SHOULD BE FACING UPWARDS AND IS COMPATIBLE FOR THE BELOW BRANDS. FOR OTHERS MENTIONED ABOVE, FLIP THE SEAL SO THE LIP FACES DOWN INTO THE RECESS OF THE WARMER FOR THE BEST SEAL.

AVENT
LANSINOH
CHU CHU
COMBI
UPIS

PA/PP BOTTLE
PP BOTTLE
PP BOTTLE
PP BOTTLE
PPSU/PP BOTTLE

SPECTRA
DOUBLE HEART
SNOW BEAR
CHICCO

PP BOTTLE
PPSU/PP BOTTLE
PPSU/PP BOTTLE
PP BOTTLE

adapters

OUR N6 BOTTLE WARMER COMES WITH 3 ADAPTERS, ADDITIONAL ADAPTERS CAN BE PURCHASED SEPERATELY.

- 1 NARROW NECK (MEDELA) 39MM ADAPTER
MEDELA
SPECTRA (NARROW)
DR BROWNS (NARROW)
PIGEON (NARROW)
 - 2 WIDE NECK (MAM) 53MM ADAPTER
MAM
PIGEON (WIDE)
 - 3 TOMMEE TIPPEE ADAPTER
- CUB
LIFE-FACTORY
NANOBEBE BREAST MILK BOTTLE
& MOST NARROW NECK BOTTLES
- NANOBEBE SILICONE BOTTLE

cleaning

WHEN USING THE BOTTLE WARMER, PLEASE FOLLOW THESE INSTRUCTIONS.

! CAUTIONS

- ◆ IT IS IMPORTANT TO CLEAN THE BOTTLE WARMER PRIOR TO USING IT FOR THE FIRST TIME AND AFTER EACH USE.
- ◆ UNPLUG THE USB CHARGING CABLE, AND LONG PRESS FOR TWO SECONDS TO SWITCH OFF THE UNIT. CLEAN THE TOP STAINLESS STEEL PARTS OF THE BOTTLE WARMER AND THE WATERPROOF SEALING RING INSIDE THE STAINLESS STEEL AND ALLOW TO DRY.
- ◆ DURING CLEANING, YOU CAN WIPE THESE PARTS CLEAN WITH A CLEAN SOFT CLOTH. DO NOT LOSE THE WATERPROOF SEAL. WHEN YOU HAVE FINISHED WARMING THE MILK, REPEAT THE STEPS ABOVE AND CLEAN THE BOTTLE WARMER AGAIN.

descaling

DEPENDING ON THE FREQUENCY OF USE, IT IS RECOMMENDED TO DESCALE THE BOTTLE WARMER EVERY MONTH TO ENSURE ITS EFFICIENCY.

! CAUTIONS

- ◆ DESCALE THE BOTTLE WARMER WITH A MIXTURE OF WHITE VINEGAR AND COLD WATER. TURN ON THE HEATING FUNCTION AND TURN OFF THE BOTTLE WARMER AFTER 5 MINUTES OF OPERATION. LEAVE THE SOLUTION IN THE BOTTLE WARMER UNTIL ALL THE LIMESCALE HAS DISSOLVED.
- ◆ THOROUGHLY CLEAN AND DRY THE STAINLESS STEEL BOTTLE, DUST CAP, SEALING RING AND ADAPTER OF THE BOTTLE WARMER.

NOTE: YOU CAN ALSO USE CITRIC ACID DESCALER, DO NOT USE OTHER TYPES OF DESCALER.

WARNINGS

- ◆ THE PRODUCT SHOULD BE USED UNDER ADULT SUPERVISION. DO NOT USE THE PARTS OF THE PRODUCT AS TOYS AND KEEP THE UNUSED PARTS OUT OF THE REACH OF CHILDREN WHEN NOT IN USE.
- ◆ BEFORE EACH USE, CHECK THE CONDITION OF THE PRODUCT.
- ◆ DO NOT USE HARSH DETERGENTS OR ANTIBACTERIAL CLEANERS TO CLEAN THIS PRODUCT. HIGHLY CONCENTRATED DETERGENTS CAN CAUSE PLASTIC PARTS TO DISINTEGRATE.
- ◆ IN THE EVENT OF BREAKAGE, REPLACE THE PARTS IMMEDIATELY WITH NEW ONES.
- ◆ WASH YOUR HANDS THOROUGHLY AND ENSURE THAT SURFACES ARE CLEAN BEFORE TOUCHING THE DISINFECTED COMPONENTS.
- ◆ WHEN NOT IN USE, DO NOT PLACE IT IN DIRECT SUNLIGHT, NEAR A HEAT SOURCE OR DISINFECTION SOLUTION FOR LONG PERIODS, OTHERWISE IT COULD REDUCE THE LIFESPAN OF THE PRODUCT.
- ◆ BREAST MILK SHOULD NOT BE HEATED FOR TOO LONG. AFTER THE PRODUCT HAS BEEN HEATED TO THE SPECIFIED TEMPERATURE, YOU CAN USE THIS PRODUCT TO KEEP YOUR BREAST MILK WARM, BUT IT IS RECOMMENDED NOT TO EXCEED 30 MINUTES OF KEEPING WARM, AS OVER 30 MINUTES MILK QUALITY CAN DETERIORATE AND BE DETRIMENTAL TO YOUR BABY'S HEALTH.

- ◆ WHEN YOU HAVE FINISHED WARMING YOUR MILK WITH THE PORTABLE BOTTLE WARMER, CHECK THAT THE MILK IS AT THE RIGHT TEMPERATURE BEFORE FEEDING YOUR BABY BY TESTING IT ON THE BACK OF YOUR HAND.
- ◆ THE HEATING TIMES PROVIDED IN THESE OPERATING INSTRUCTIONS ARE REFERENCE VALUES ONLY. THE ACTUAL HEATING TIME IS INFLUENCED BY THINGS, SUCH AS AMBIENT TEMPERATURE, BOTTLE MATERIAL, STARTING TEMPERATURE, MILK QUANTITY, ETC.
- ◆ DO NOT TOUCH THE METAL STAINLESS STEEL PARTS OF THE PORTABLE BOTTLE WARMER DURING HEATING TO AVOID BURNS.
- ◆ IT IS RECOMMENDED THAT THE PRODUCT IS MATCHED WITH AN ADAPTER THAT MEETS LOCAL SAFETY REQUIREMENTS (INPUT: 100-240V - 50/ 60HZ-0.45A OUTPUT: 5.0V3A) FOR USE WITH LOCAL SAFETY REQUIREMENTS.
- ◆ THIS BOTTLE WARMER HAS A BUILT-IN LI-ION RECHARGEABLE BATTERY. IT SHOULD NOT BE USED IN AN ENVIRONMENT WITH STRONG STATIC ELECTRICITY OR MAGNETIC FIELDS TO AVOID DAMAGING THE BATTERY'S SAFETY PROTECTION DEVICE AND POSING POTENTIAL DANGER.
- ◆ PLEASE UNPLUG WHEN FULLY CHARGED, PROLONGED CHARGING MAY LEAD TO FIRE AND OTHER SAFETY INCIDENTS.

COMMON PROBLEMS AND MAINTENANCE

CAN I USE THIS PRODUCT TO KEEP MY WATER/BREAST MILK WARM ALL NIGHT?

1. YOU CAN USE THIS PRODUCT TO KEEP WATER WARM ALL NIGHT.
2. YOU CAN USE THIS PRODUCT TO KEEP BREAST MILK WARM, BUT IT IS RECOMMENDED NOT TO EXCEED 30 MINUTES OF KEEPING WARM, AS OVER 30 MINUTES MILK QUALITY CAN DETERIORATE AND BE DETRIMENTAL TO YOUR BABY'S HEALTH.

WHAT SHOULD I DO IF A WHITE SPOT APPEARS IN THE HEATED PAN?

THE WHITE SPOTS ARE LIMESCALE DEPOSITS, WHICH ARE HAZARDOUS TO YOUR BABY'S HEALTH. IT IS RECOMMENDED TO USE PURE OR DISTILLED WATER FOR FEEDING TO AVOID LIMESCALE FROM HEATING TAP WATER. IF LIMESCALE APPEARS, ADD A SMALL AMOUNT OF WHITE VINEGAR OR CITRIC ACID DESCALING AGENT, TURN ON THE HEATING FUNCTION AND TURN IT OFF AFTER 5 MINUTES OF OPERATION. LEAVE THE SOLUTION IN THE BOTTLE WARMER UNTIL ALL THE LIMESCALE HAS DISSOLVED. DO NOT USE OTHER TYPES OF DESCALING AGENTS.

WHAT IS THE BEST TEMPERATURE OF WATER FOR BABIES?

1. 37°C-40°C FOR HEATING PROTEIN POWDER/PROBIOTICS.
2. 40°C-45°C FOR HEATING MILK POWDER, BREAST MILK AND DRINKING WATER.

WHY IS IT TAKING LONGER TO HEAT?

THE LOWER THE AMBIENT TEMPERATURE, THE LOWER THE STARTING POINT OF THE WATER TEMPERATURE, THE LONGER THE HEATING TIME WILL BE.

DRY BURN PROTECTION ALARM

IF THE STAINLESS STEEL PART IS NOT FILLED WITH A BOTTLE WITH BREAST MILK OR WATER, A DRY BURN ALARM WILL BE TRIGGERED. A LONG BEEP WILL SOUND 3 TIMES AND THE DISPLAY WILL SHOW R01.

NTC FAULT PERFORMANCE:

IF WHEN YOU TURN YOUR BOTTLE WARMER ON IT BEEPS THREE TIMES, DISPLAYS THE ERROR CODE OF 002 & ALSO CAN'T HEAT OR SHUT DOWN, PLEASE CONTACT THE PLACE OF PURCHASE OR THE MANUFACTURER

WHY IS THE DRY BOIL ALARM ON WHEN THERE IS WATER IN THE BOTTLE?

WHEN ADDING HOT WATER, IT IS BEST TO WAIT FOR 10-30 SECONDS BEFORE STARTING THE MACHINE, THIS WILL REDUCE THE TEMPERATURE DIFFERENCE BETWEEN THE LIQUID AND THE BASE SO THAT IT IS NOT MISTAKEN AS DRY BURNING & TRIGGER THE AUTOMATIC SAFETY SHUT OFF

any questions?

PLEASE CONTACT US AT

LACEVO.COM